

**DC Motorized Impeller
Backward Curved
Ø220x63mm**



Impeller:	Plastic PA6.6+GF
Motor:	DC Brushless External Rotor Motor
Rotor:	Original Aluminum Sheet Color
Bearing:	Dual Ball Bearing
Insulation:	Class "A" or "B"
Technical Features:	PWM Speed Control; Alarm Output; Locked Rotor Protection; Soft Start.
Operating Temp.:	-20°C to +60°C
Weight:	1400 g

Model Number	Voltage (VDC)	Op.Voltage (VDC)	AirFlow (CFM)	AirFlow (m ³ /H)	StaticPres. (mm-H ₂ O)	StaticPres. (inH ₂ O)	Noise (dBA)	Speed (RPM)	Current (A)	Power (W)	Curves
FDI22063B24W7-57	24	16.0~28.0	453.00	769.60	46.10	1.80	64.70	2,800	4.0	96.00	①
FDI22063B48W7-57	48	36.0~56.0	453.00	769.60	46.10	1.80	64.70	2,800	2.0	96.00	①

Specifications are subject to change without notice

Characteristic Curves:

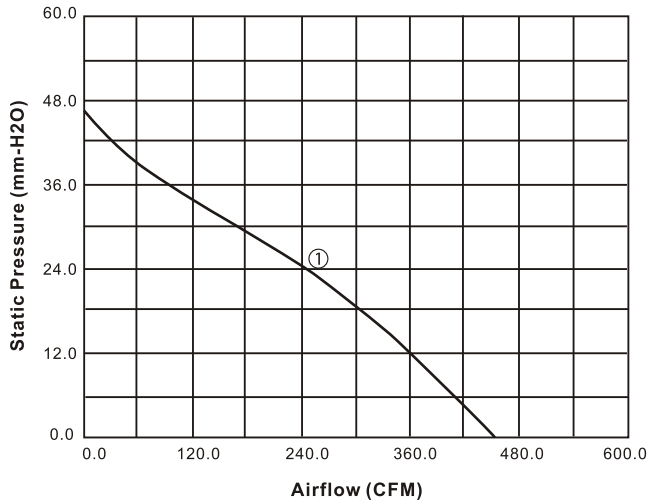

Outline Drawing:

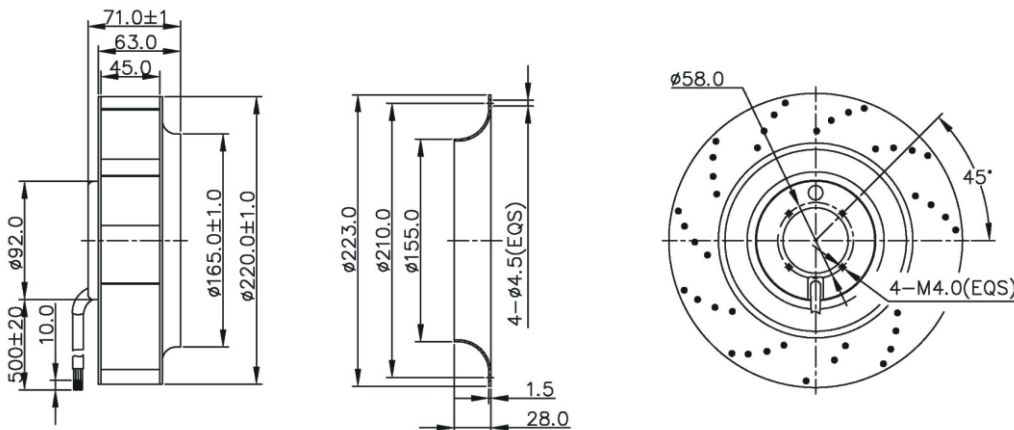

Inlet Ring

Unit:mm